

# Split

demountable partitions

IOC project partners

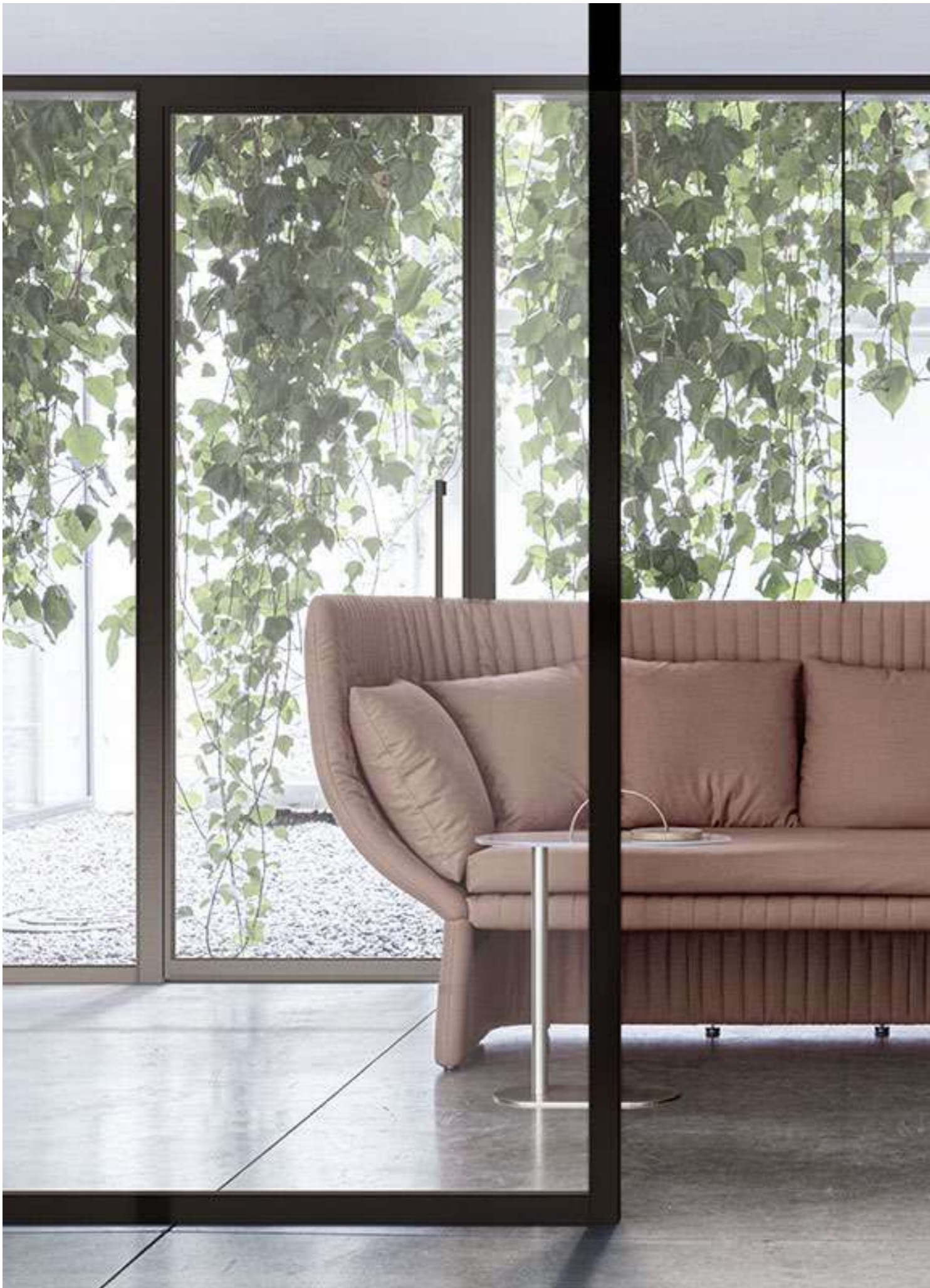



# Split

## Partitioning

- EN Workspaces organization is important, Split responds to the need to create separate spaces in a working environment: private offices, meeting rooms, open spaces, lounge or catering areas. Light and minimal, Split is a demountable partitions system that, thanks to its easy installation, well suits for every context and building. The system offers many accessories and it's available in different finishes.
- IT L'organizzazione degli spazi di lavoro è importante, Split risponde all'esigenza di creare in un ambiente lavorativo spazi separati: uffici privati, sale riunioni, openspace, aree lounge o per la ristorazione. Leggero e minimale, Split è un sistema di pareti divisorie che grazie alla sua facilità di montaggio ben si adatta ad ogni contesto ed edificio. Il sistema è dotato di molteplici accessori e disponibile in diverse finiture.





- EN Split is minimal: aluminum profiles are thin, simple and light.
- IT Split è minimale: i profili in alluminio sono sottili, semplici e leggeri.





EN Split is easy to install. Thanks to the possibility to optimize height of glass, jambs and doors, Split allows an easy and fast installation.

IT Split è facile da montare. Grazie alla possibilità di ottimizzare le misure in altezza di vetri, stipiti e porte, Split consente una facile e veloce installazione.

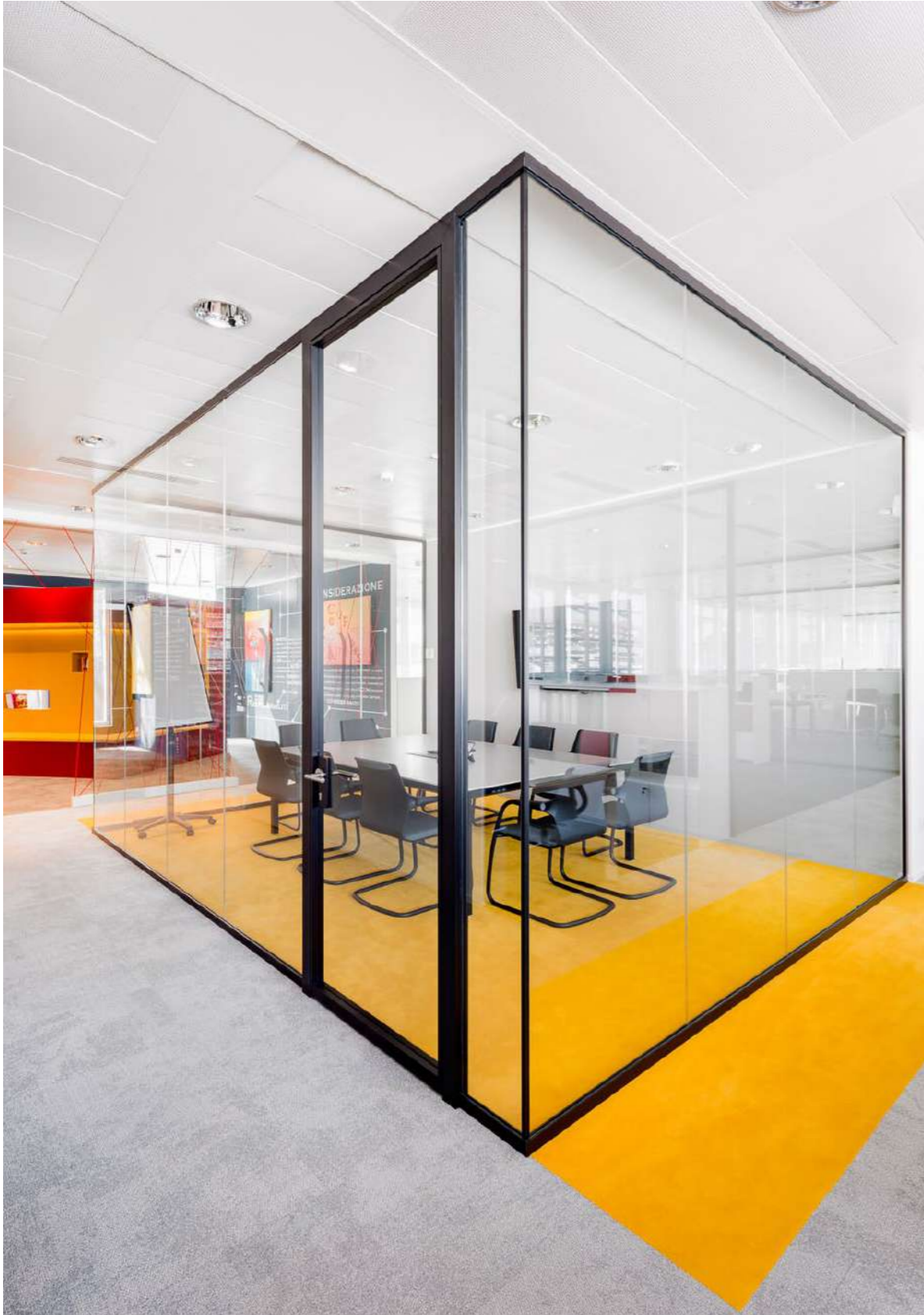



EN Split is versatile, customizable and can be adapted to different needs. Available as single and double glazed as well as solid. The aluminum profiles can be anodized, painted or veneered.

IT Split è versatile e personalizzabile. La parete divisoria Split può essere adattata a diverse esigenze; molteplici sono le tipologie disponibili: mono vetro al centro, mono vetro filo esterno, doppio vetro o cieca. L'alluminio può essere anodizzato, verniciato oppure rivestito in legno.



EN Split is accessorised with room scheduler, lever handles, pull handles, locks, switches and plugs.

IT Split è predisposta per: room scheduler, maniglie, maniglioni, serrature, interruttori e prese.

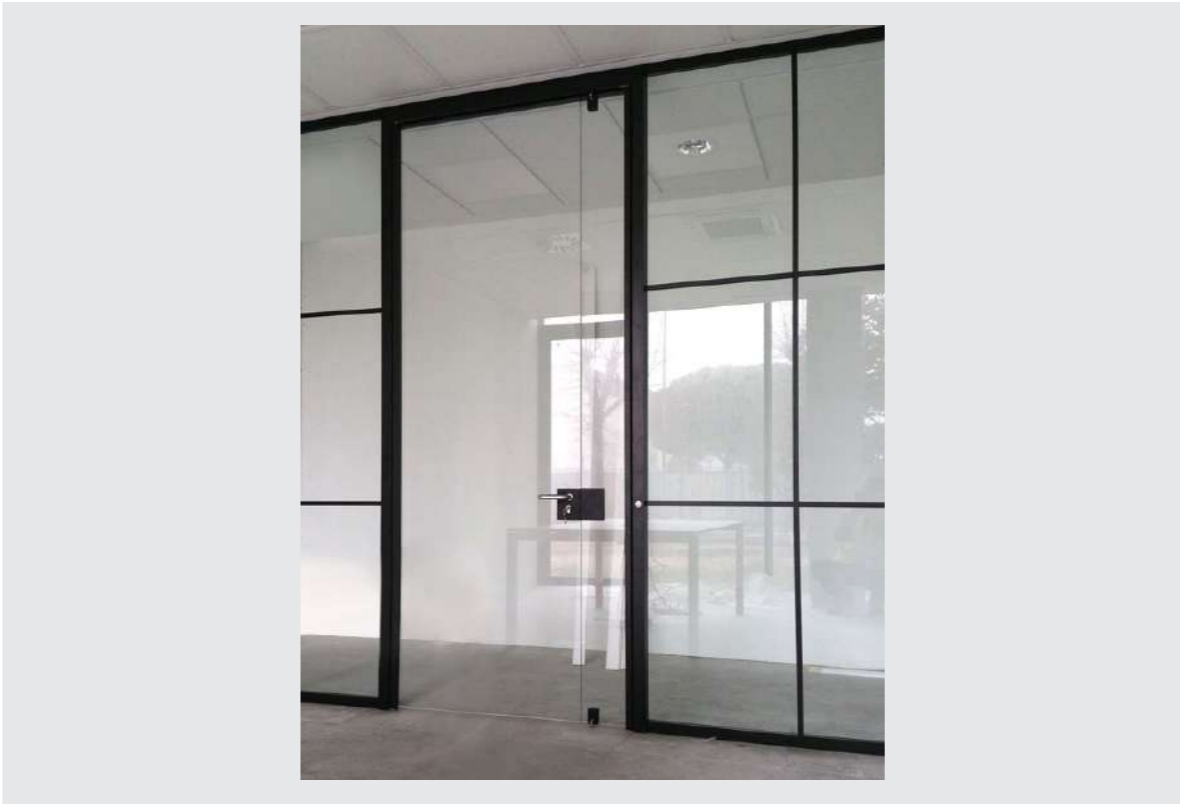

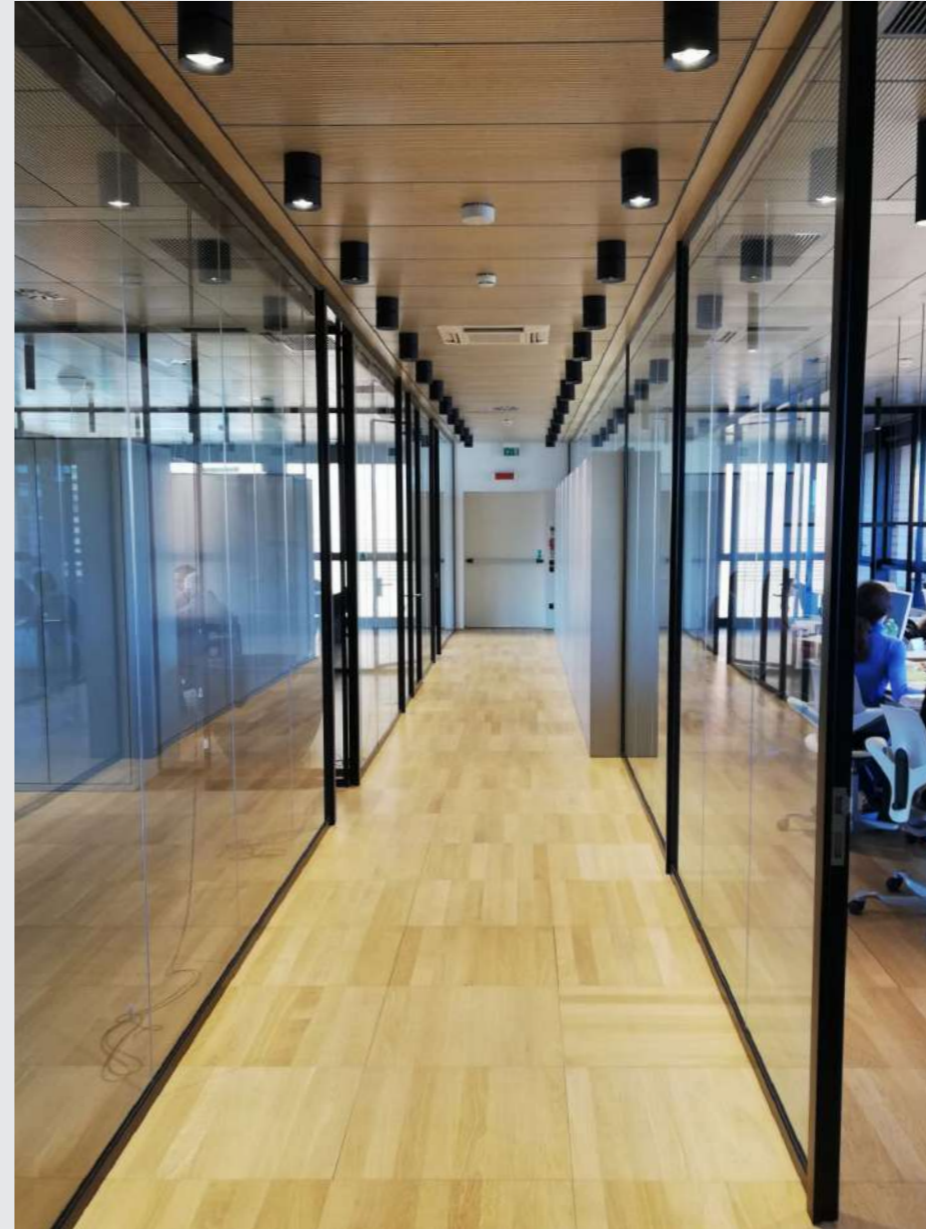



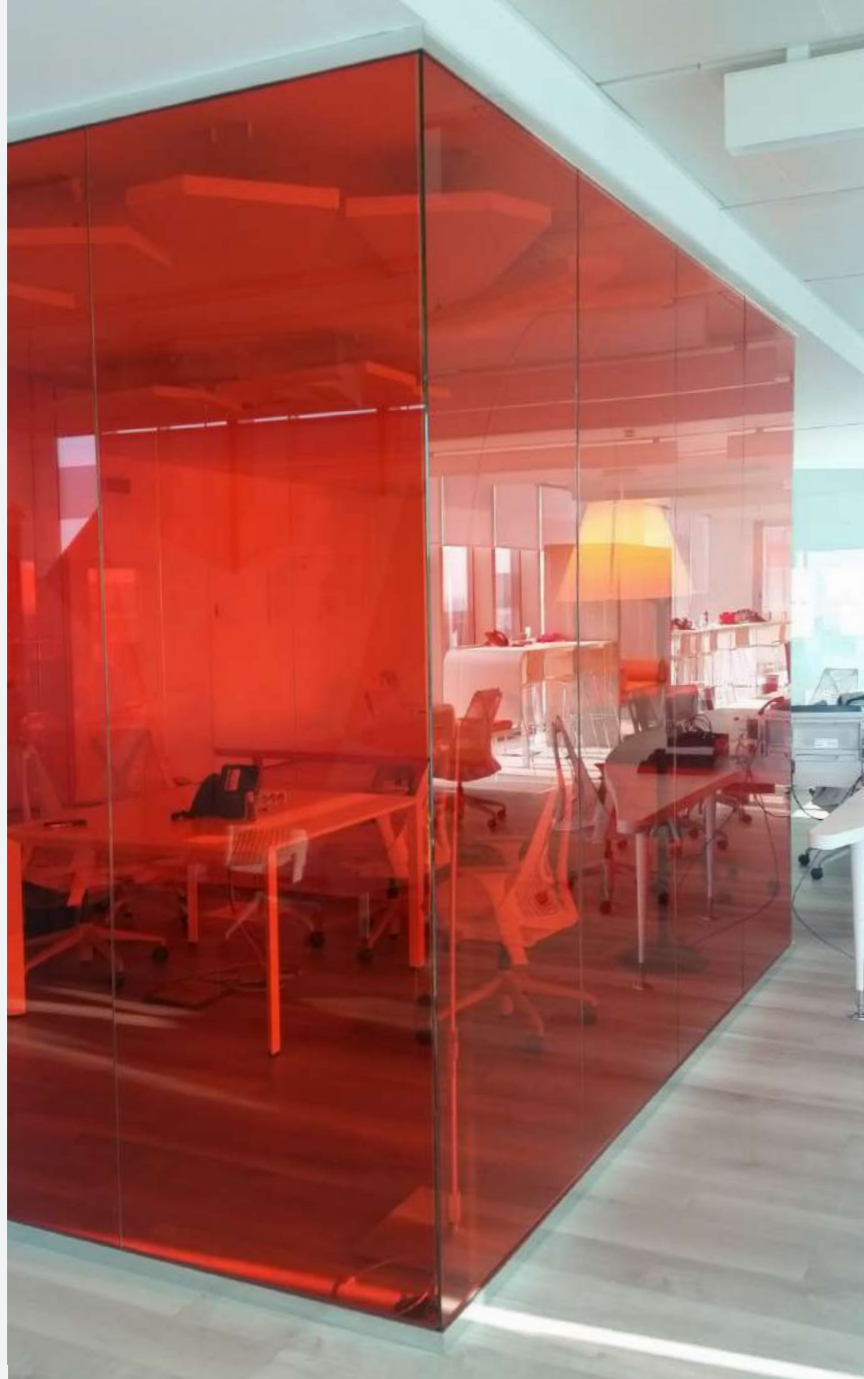



# Technical details / Dettagli tecnici

---

## EN **Demountable glazed or solid partitions system**

- Single glazed with 1 3/16" (30 mm) profiles.
- Double glazed with 2 3/16" (55 mm) profiles.
- Offset single glazed with 2 3/16" (55 mm) profiles.
- Solid with double 5/8" (16 mm) paneling and 1 3/16" (30 mm) tracks. (Tot. th. 2 7/16").

### **Dimensions**

- Overall 2 7/16" (62 mm) thickness at door jamb.
- Standard glazed module 39 3/8" (1000 mm).
- Standard vertical solid module 39 3/8" (1000 mm).
- Standard horizontal solid module 39 3/8" (1000 mm) / 78 3/4" (2000 mm) / 118 1/8" (3000 mm).
- Maximum height 10'-0" (3050 mm).
- For heights higher than 10' the system with 9/16" (8+6 mm) glass is recommended.

### **Profiles**

Oxidised aluminium in natural or polished finish.  
Alternatively, powder coated to RAL 9010 and 9005.  
Floor profile allows a tolerance of +5/8" (15 mm).  
Ceiling profile allows a tolerance of +/- 3/8" (10 mm).

### **Glass**

Laminated glass with normal or acoustic pvb interlayer.

Available thicknesses:

- 5 + 5 + pvb 0.38 (35 dB) or 0.76 (39 dB).
- 6 + 6 + pvb 0.38 (36 dB) or 0.76 (40 dB).
- 8 + 6 + pvb 0.38 (37 dB) or 0.76 (40 dB).

### **Joints**

Junctions between glass panels: transparent polycarbonate profiles (in-line, 90 ° angle and 3-way).

### **Panels**

Panels in wood agglomerate, scratch resistant melamine or lacquered in standard colour (class 2 fire resistance).

# Technical details / Dettagli tecnici

---

IT

## **Sistema di parete divisoria vetrata o cieca**

- Mono vetro con guida sp. 30 mm.
- Doppio vetro con guida sp. 55 mm.
- Mono vetro a filo esterno con guida sp. 55 mm.
- Cieca con pannelli da 16 mm. e guida sp. 30 mm (spessore totale 62 mm).

## **Dimensioni**

- Spessore totale in corrispondenza dello stipite porta, 62 mm.
- Moduli vetro standard L.100 cm circa.
- Pannelli verticali: L.100 cm.
- Pannelli orizzontali: L.100/200/250 cm.
- Altezza massima H.300 cm. (per altezze superiori ai 3 m. si consiglia l'utilizzo di vetro 8+6 mm).

## **Profili**

Realizzati in alluminio anodizzato naturale o lucido. In alternativa, verniciato nei colori della cartella RAL 9010 e 9005.

Il profilo a pavimento consente l'inserimento di spessori per ottenere un livellamento con tolleranza +15 mm. Il profilo a soffitto consente una tolleranza di +/- 10 mm.

## **Vetro**

Lastre di cristallo stratificato trasparente o extrachiaro, con interposto Pvb normale o acustico, realizzate a misura.

- 5 + 5 + pvb 0.38 (35 dB) o 0.76 (39 dB)
- 6 + 6 + pvb 0.38 (36 dB) o 0.76 (40 dB)
- 8 + 6 + pvb 0.38 (37 dB) o 0.76 (40 dB)

## **Giunti**

Policarbonato trasparente o alluminio (in linea, angolo 90°, 3-vie).

## **Pannelli**

In agglomerato ligneo, nobilitato in materiale melaminico o laccato, con resistenza al fuoco classe 2.

# Single Glazed - Monovetro

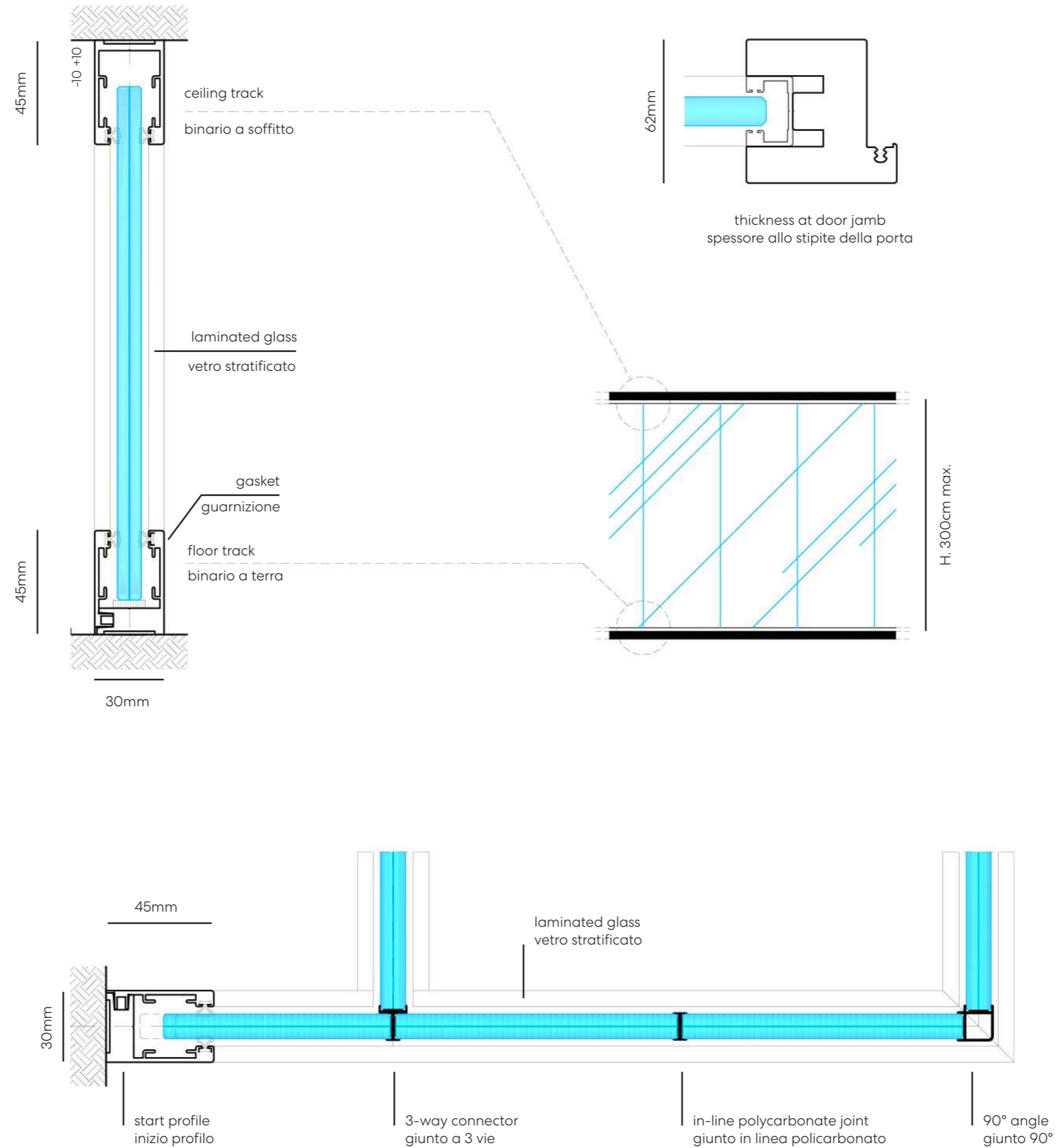

# Offset Single Glazed - Monovetro Filo Esterno

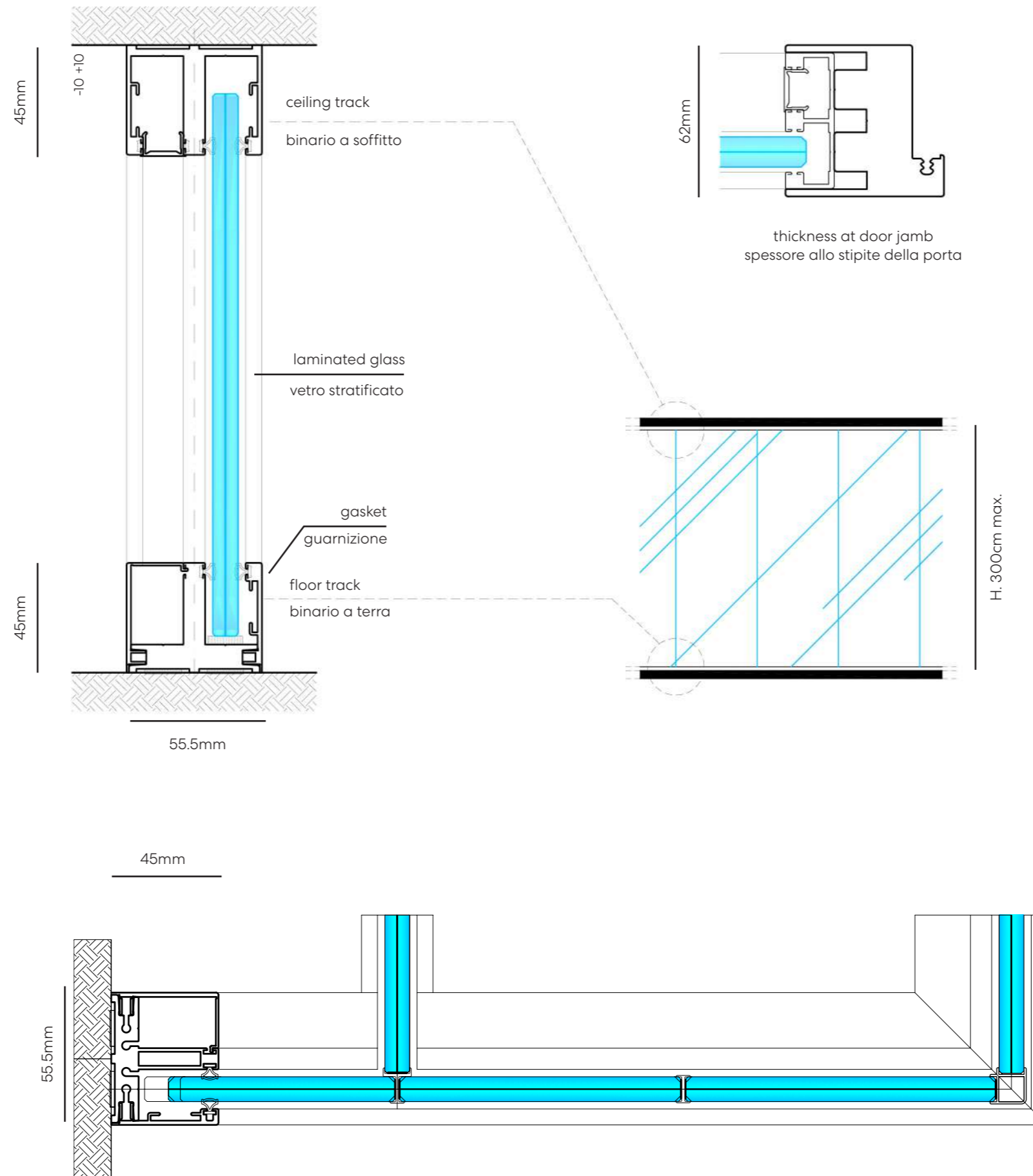

# Double Glazed - Doppio Vetro

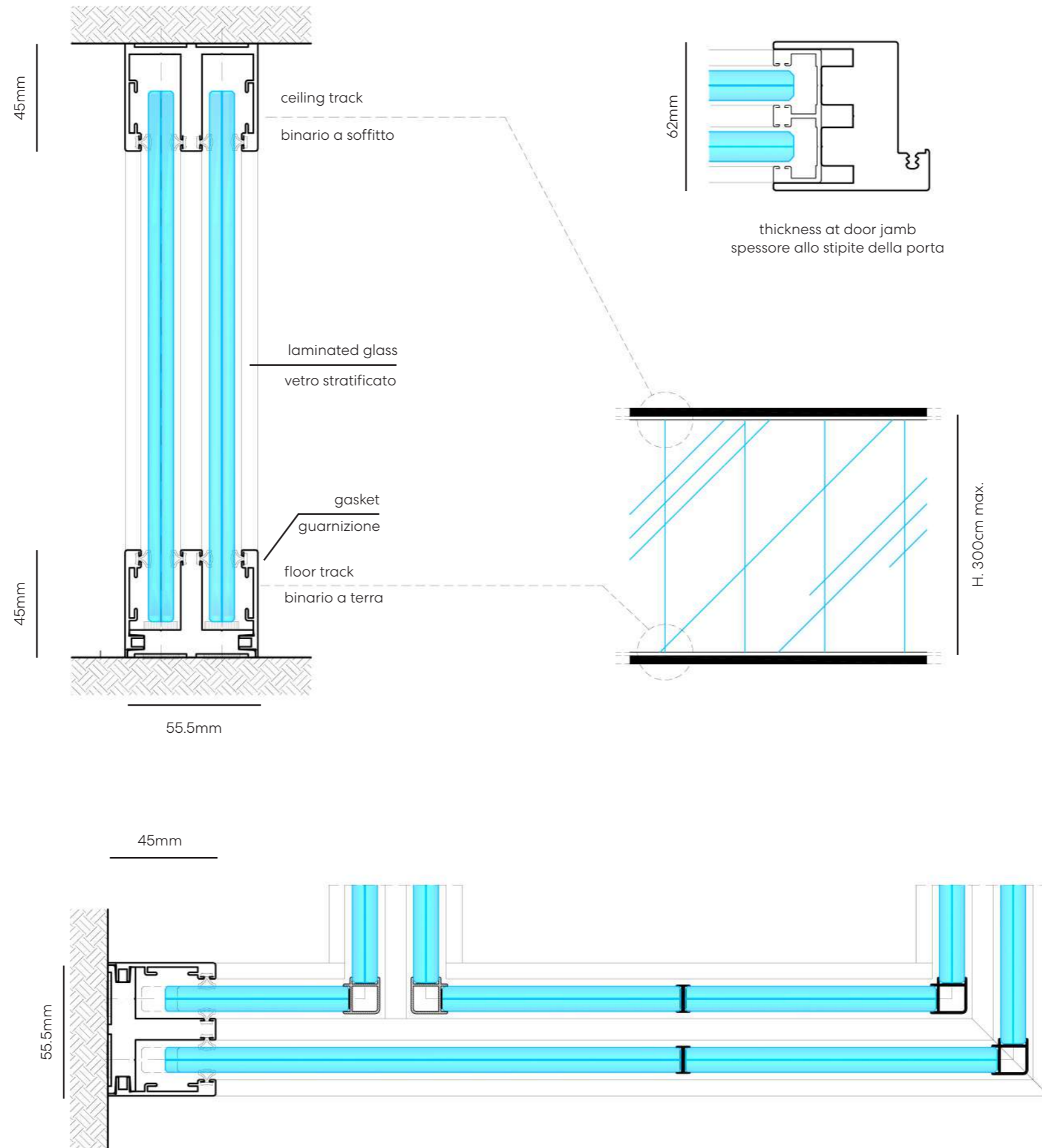

# Doors / Porte

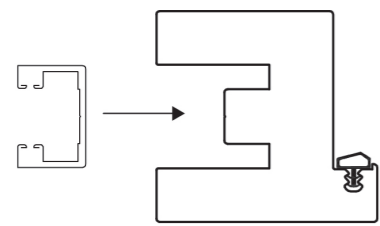

- Jamb for single glazed  
- Stipite per vetro singolo

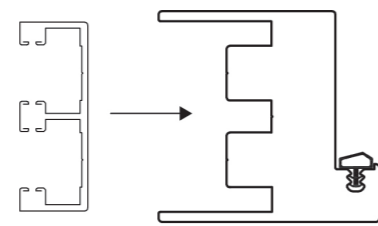

- Jamb for double glazed  
- Stipite per vetro doppio

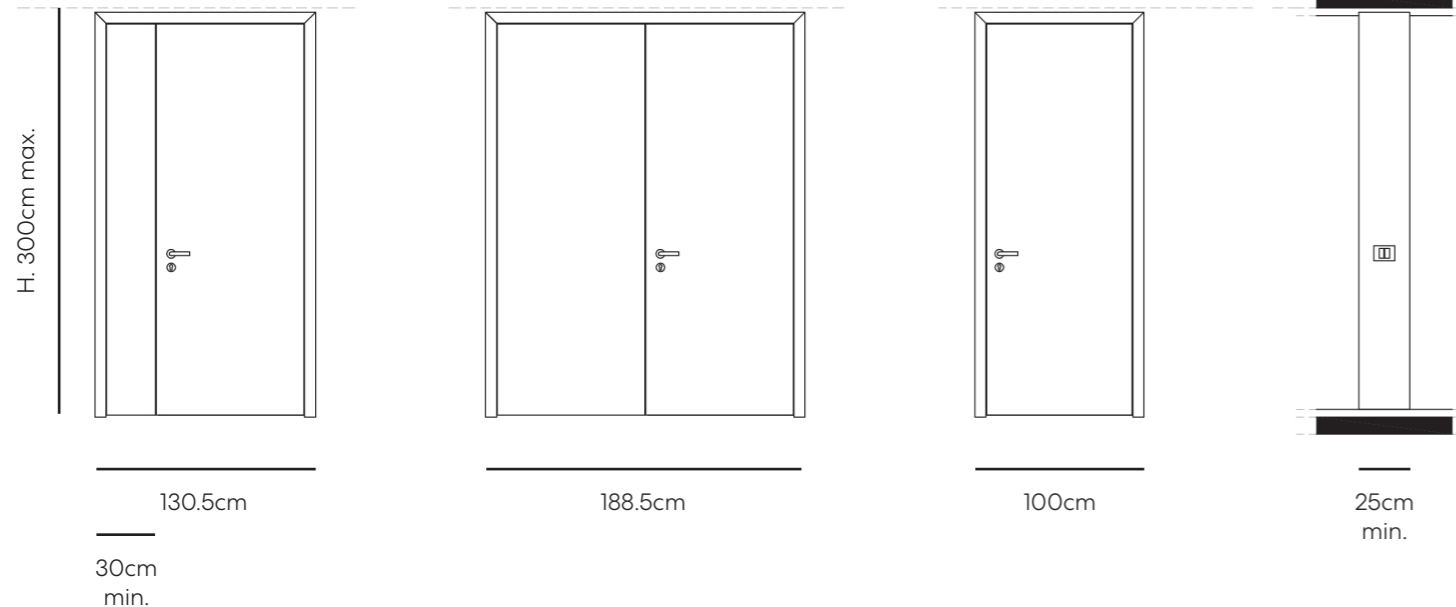

EN Door leaf and aluminium frame with 45° mitred corners, in single or double glazed configuration. Integrated in the system or on masonry / drywall.

- Door height floor to ceiling max. 10'-0" (3050 mm).
- Width of single leaf doors 39 3/8" (1000 mm).
- Width of double winged doors 74 3/16" (1885 mm).

It is possible to make doors with main leaf and semi-fixed leaf width (Total width 51 3/8" - 1305 mm).

### Glazed doors

In the following versions:

- Frameless with polished edges,
- Framed, single centered, single offset or double glazed.

### Solid door

- 1 5/8" (42 mm) swing. Available in: lacquered, laminate, melamine, essence.
- 2 3/8" (60 mm) swing. Available in: lacquered, laminate, melamine, essence.

**Sliding door** version with ceiling fixed track. Frameless polished edge door, th. 10mm with bar handle.

Possibility of cut-outs on the door jamb to accommodate single or double switches (Bticino or Omega button).

- AGB Lock for solid or glazed door (2 3/8" - 60 mm.)
- HCS Lock for glazed door (3/8" - 10mm.)
- Magnetic lock for solid door (1 5/8" - 42 mm.)
- Standard lever handle
- Possibility of integrating electric strikes, drop seal or door closer.

# Doors / Porte

---

IT Le porte sono costituite da un battente e da un telaio/stipite in alluminio assemblato con taglio a 45°, nelle versioni per parete mono vetro e doppio vetro.

- Altezza da pavimento a soffitto 300 cm. max.
- Larghezza porte a singolo battente L. 100 cm.
- Larghezza porte a doppio battente L. 188,5 cm.

E' possibile realizzare porte con anta principale di serie e antello semi-fisso di larghezza non inferiore a 30 cm. (larghezza totale porta L. 130,5 cm).

## **Porte vetro singolo o doppio**

Nelle versioni:

- Vetro a filo molato lucido a vista sp. 10 mm.
- Vetro intelaiato singolo centrale, singolo a filo esterno o doppio

## **Porte cieche**

In legno tamburato laccato, placcato con laminato o essenze, di spessore 42 o 60 mm.

- Battente da 42 mm. disponibile in: laccato, laminato, melaminico, essenza.
- Battente da 60 mm. disponibile in: laccato.

## **Tutte le porte**

- Sono realizzabili ad anta singola o doppia
- Hanno la possibilità di lavorare lo stipite per l'inserimento di interruttori singolo o doppio, serie Bticino e a pulsante Omega.

## **Sono dotate di**

- Serratura AGB (cieche e intelaiate sp.60mm.)
- Serratura HCS o art.207 N.O. (vetro a filo lucido 10mm.)
- Serratura magnetica (cieche sp.42mm.)
- Maniglia di serie, Bernina

Possibilità di dotare di incontro elettrico, ghigliottina e pompa aerea esterna o incassata.

Vano tecnico elettrificabile di sp. 62 mm. e larghezza 25 cm. min, coordinabile alle finiture della parete cieca eventualmente abbinata.

# Switches - Interruttori

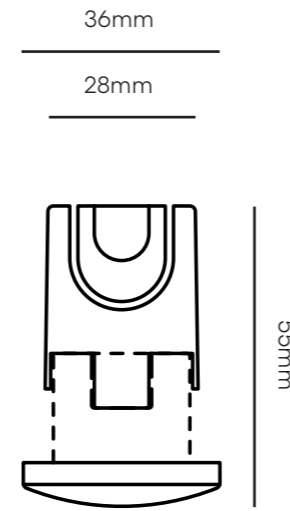
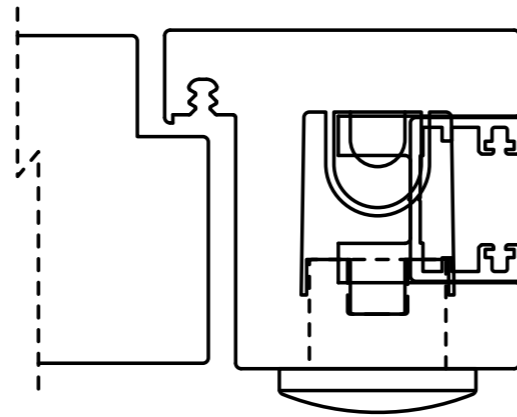

BTcino "Living" art.L 4811PA

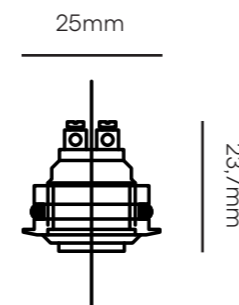
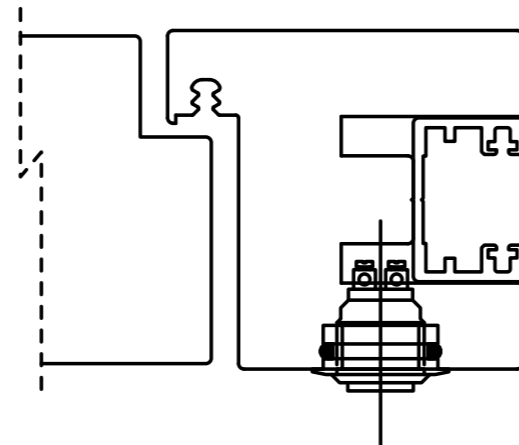

Omega art. AV0630(1X)

## Standard Doors - Porte Standard

- frameless with polished edge glass
- porta con vetro a filo lucido non intelaiato

- framed offset glass
- porta con vetro a filo esterno intelaiato

- solid door th. 60 mm
- porta cieca sp. 60 mm

- solid door th. 42 mm
- porta cieca sp. 42 mm

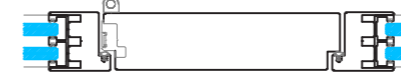
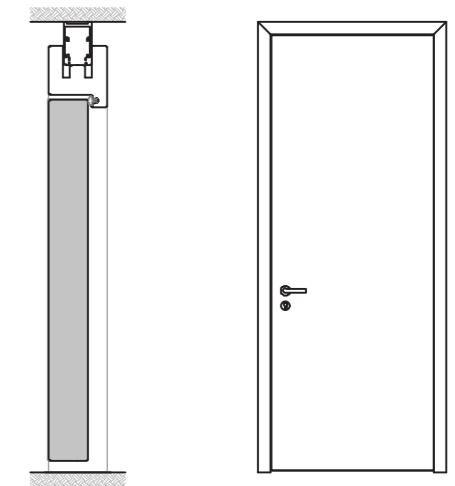
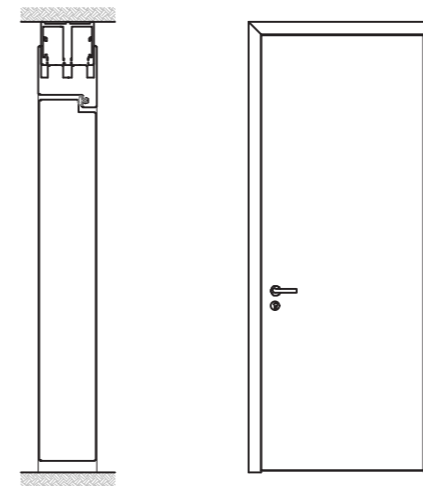
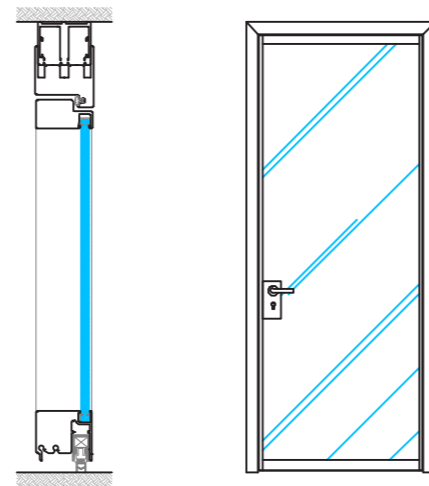
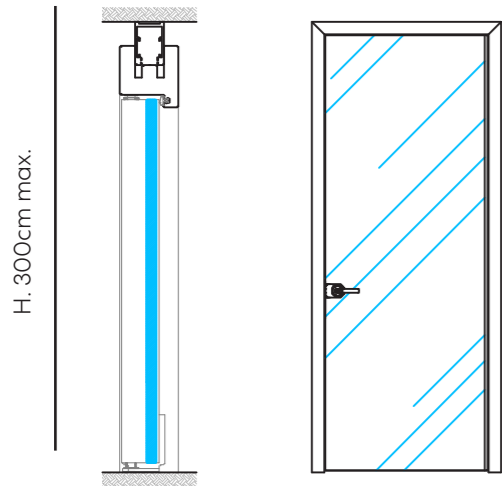

module door / modulo porta 199,4 cm

- framed centered glass
- porta con vetro centrale intelaiato

- framed double glass
- porta con doppio vetro intelaiato

- sliding door
- porta scorrevole con vetro a filo lucido non intelaiato

- door on masonry
- porta su muratura

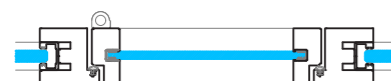
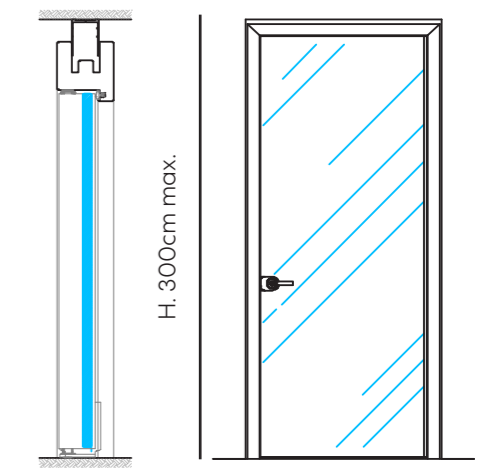
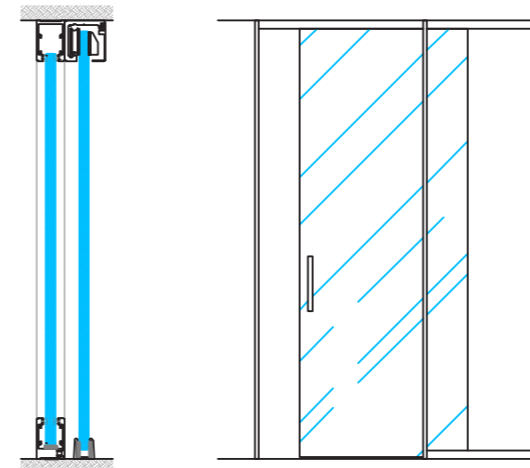
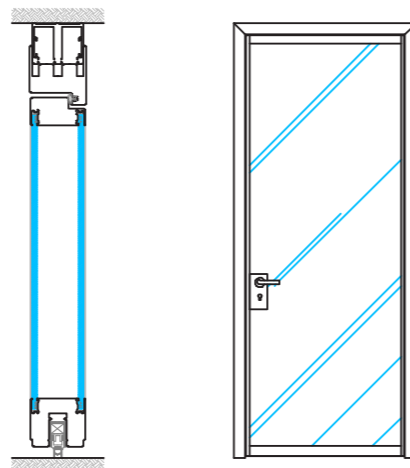
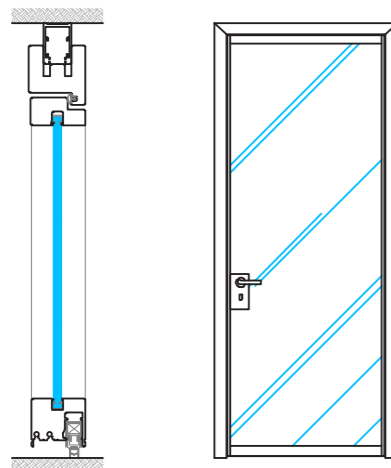

compartment / vano  
L. 102cm

**Solid Partition - Parete Cieca:  
Vertical panels - Pannelli verticali**

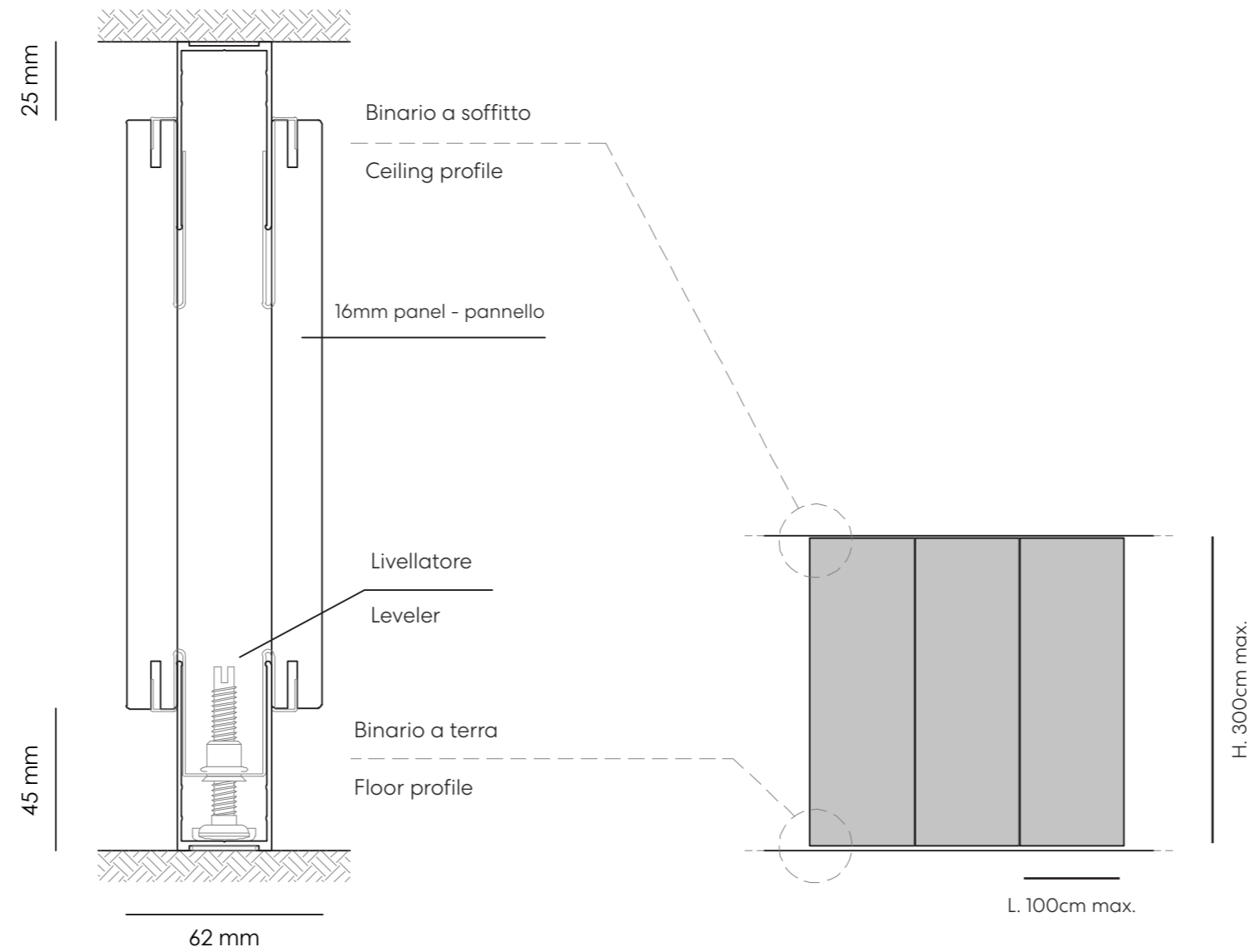

HORIZONTAL SECTION - SEZIONE ORIZZONTALE

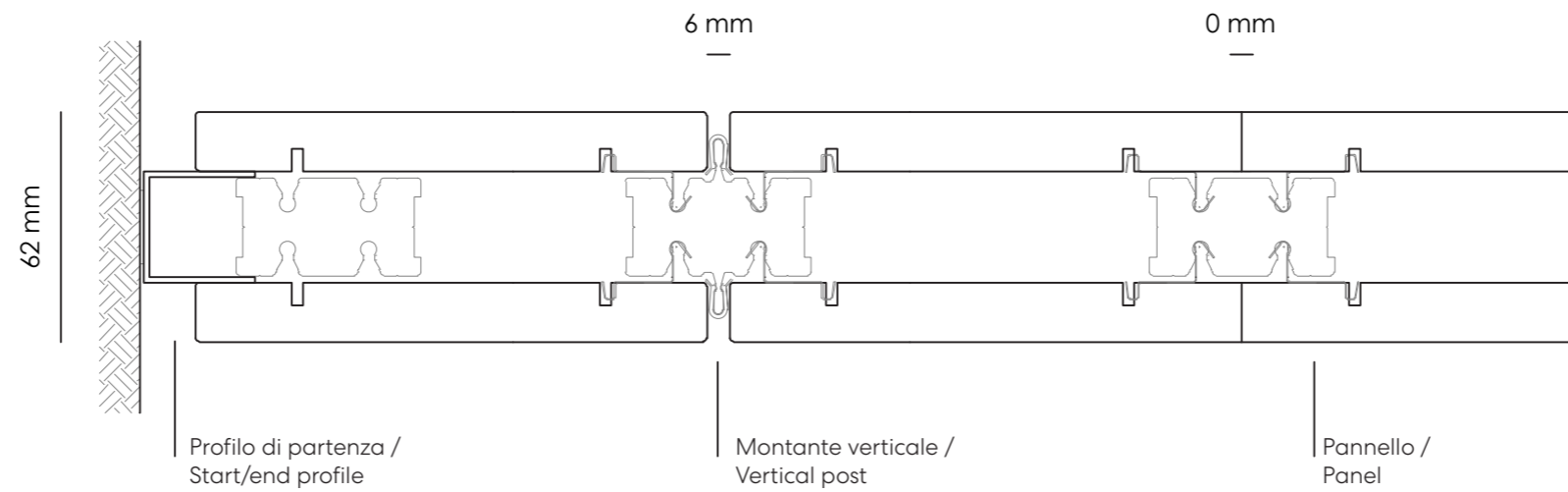

**Solid Partition - Parete Cieca:**  
**Horizontal panels - Pannelli orizzontali**

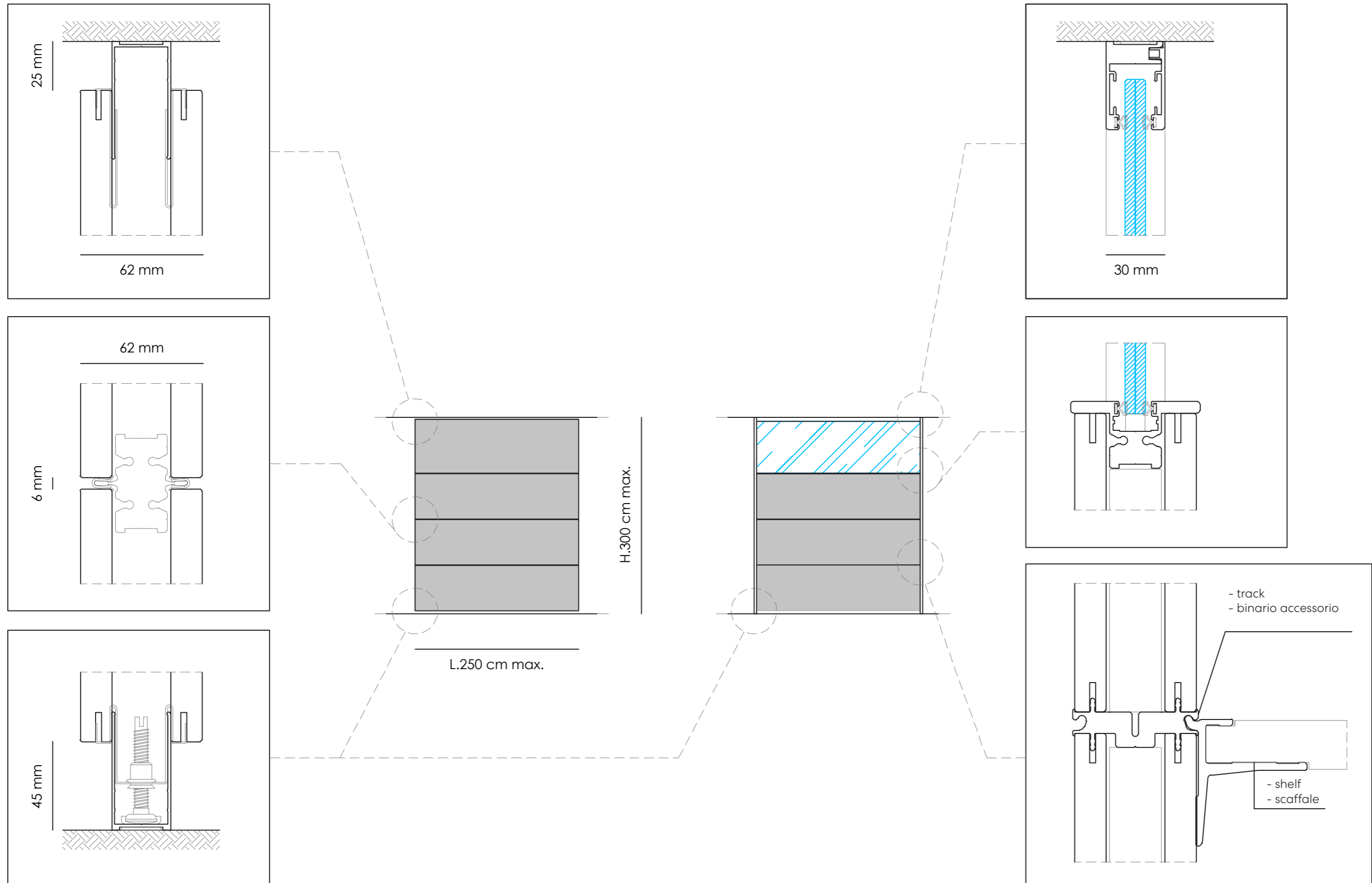

## Connector - Profili Passaggio

- connector solid partition/glass
- profilo passaggio cieco/vetro

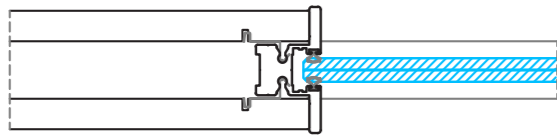

- technical module for single glass
- modulo tecnico con vetro singolo

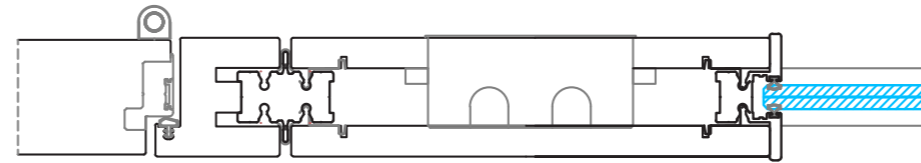

- 3 and 4-way connection
- snodi a 3 e 4 vie

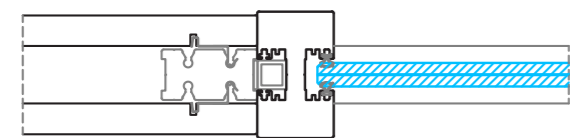
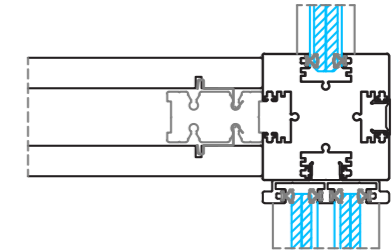

- technical module for single glass
- modulo tecnico con vetro singolo

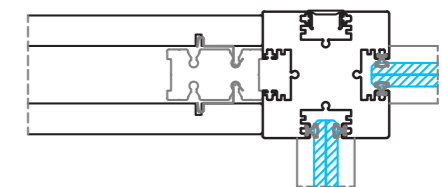
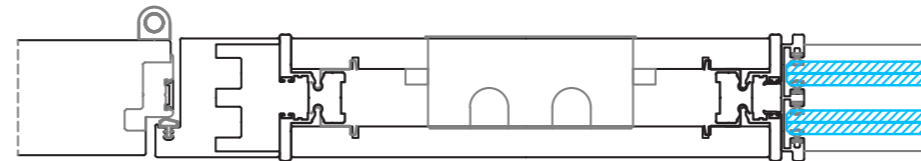

- connector solid partition/double glass
- profilo passaggio cieco/doppio vetro

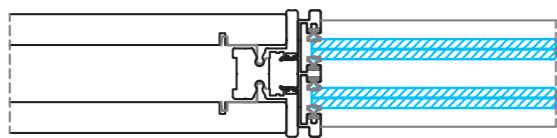

- technical module for offset single glass
- modulo tecnico con vetro singolo a filo

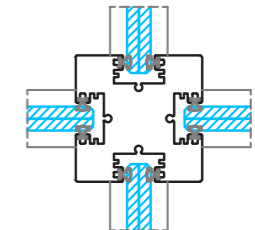
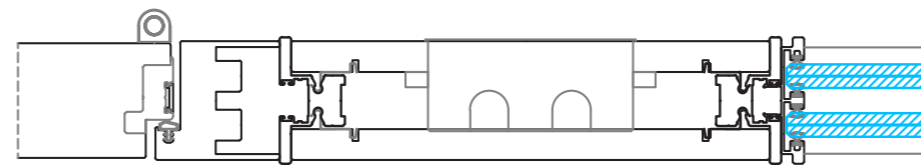

- connector solid partition/offset single glass
- profilo passaggio cieco/mono vetro a filo

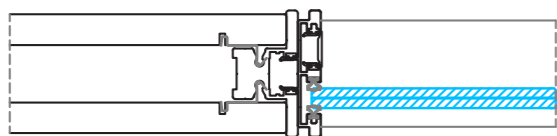

- 90° angle connector
- angolo a 90°

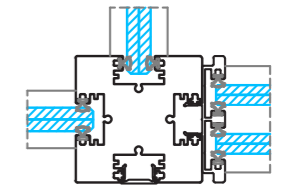
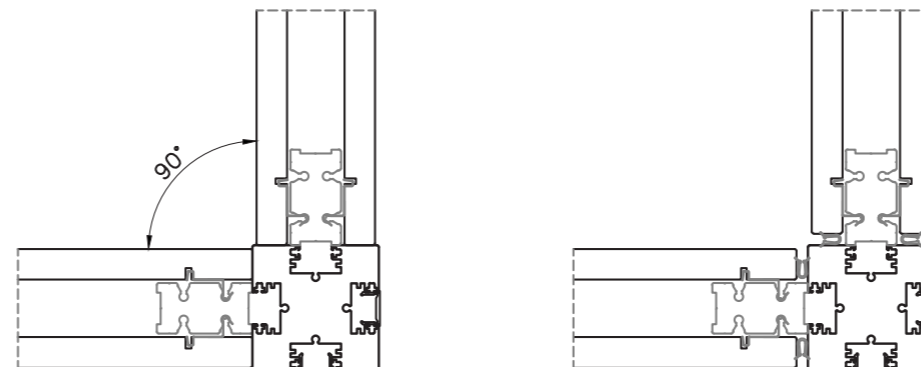

# Materials and finishes / Materiali e finiture

## Partitioning | Split

### Aluminum / Alluminio

#### Anodizing / Anodizzazione

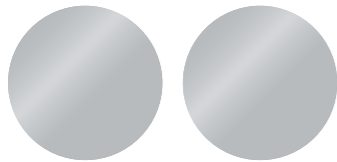

ARC - Clear  
anodized /  
Anodizzato  
chimico

ARS - Brushed  
anodized /  
Anodizzato  
spazzolato

#### Matte or polished Painting / Verniciatura opaca o lucida



White  
painted /  
Bianco 9010

Black  
painted /  
Nero 9005

### Melamine / Melaminico

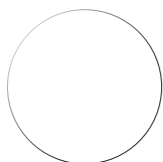

White /  
Bianco

### Glass / Vetro



Clear /  
Trasparente

Low Iron /  
Extra chiaro

- EN
- Possibility of customization according to project for painting, anodizing and wooden coating.
  - Film: colors and graphics can be defined on a project.
  - Special glass finishes available on request (etched glass, smoked glass etc).
- IT
- Possibilità di personalizzazione a progetto per verniciature, anodizzazioni e rivestimento ligneo.
  - Possibilità di applicare pellicole decorative con colore e grafica da definire a progetto.
  - Possibilità di richiedere finiture speciali da applicare ai vetri (vetro acidato, fumé ecc).

# Materials and finishes / Materiali e finiture

## Partitioning | Split

### Matt lacquer / Laccato opaco

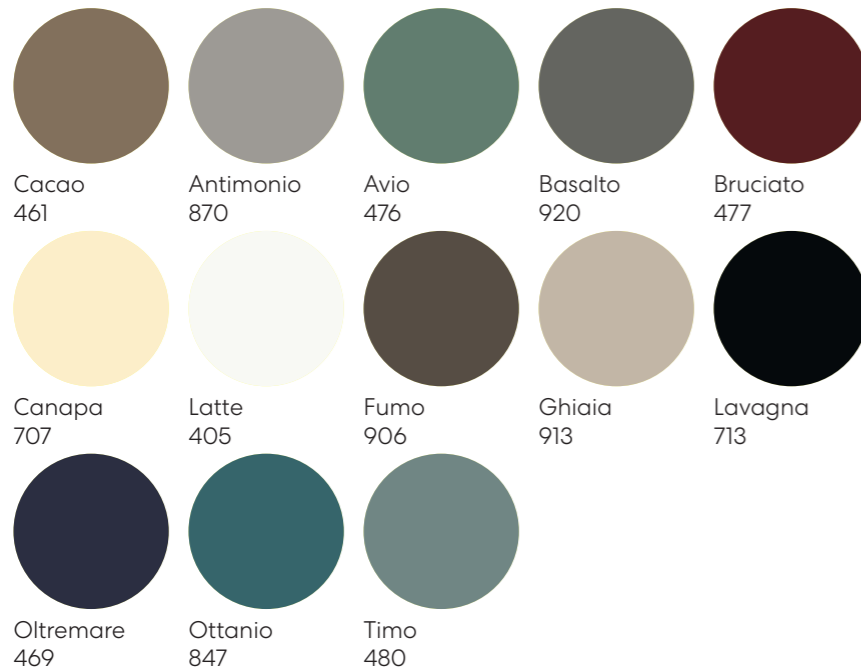

### Scratch-resistant lacquer / Laccato antigraffio

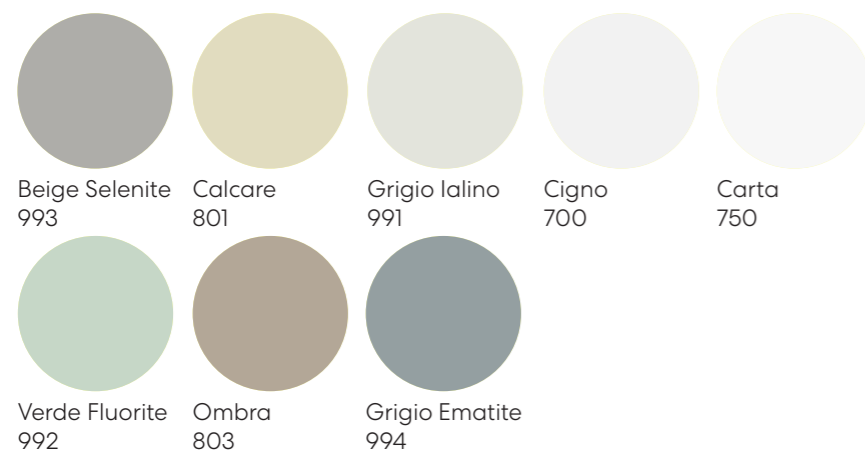

- EN - Solid partition: white melamine and lacquered  
- Film: colors or graphics must be defined on a project
- IT - Per parete cieca: melaminico bianco e laccato  
- Pellicola: colore o grafica da definire a progetto

# Split

demountable partitions

IOC project partners

